

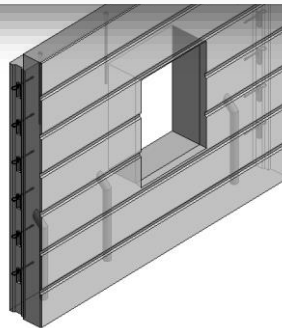

Smart Connections

Inserting elements

Insert Elements Command

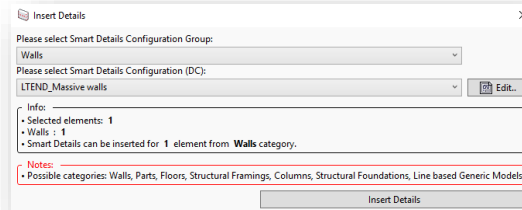
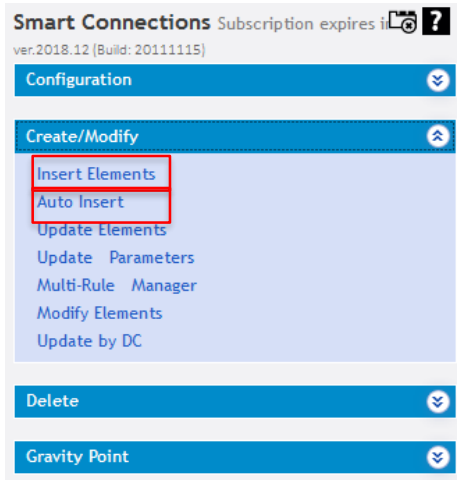
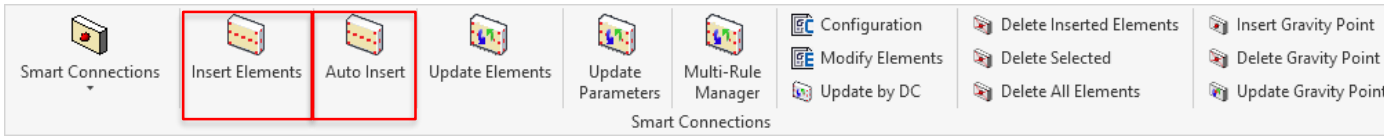
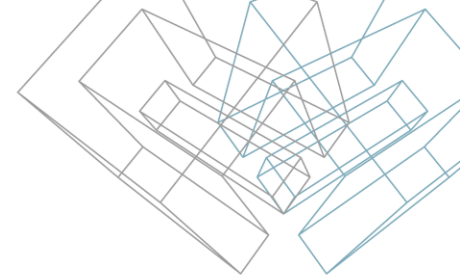

- After you have prepared your configurations, you can insert elements by using the 'Insert Elements' or 'Auto Insert' command.
- Elements that can be used for cuts and elements are point- and line-based families of these categories: Generic Models, Structural Framing, and Structural Connections.

Insert Elements by selected element

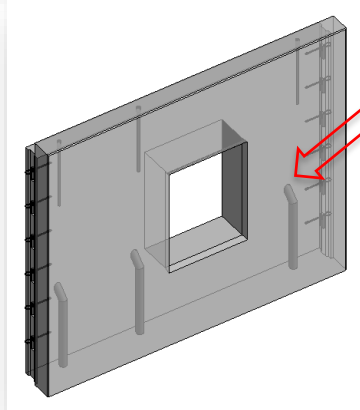
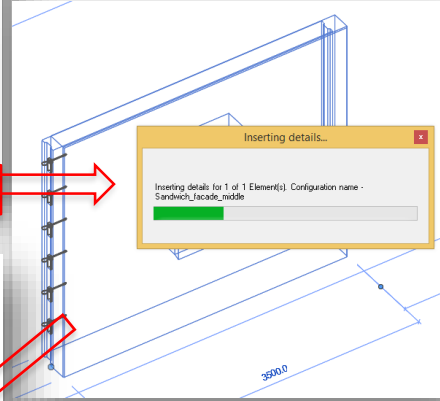
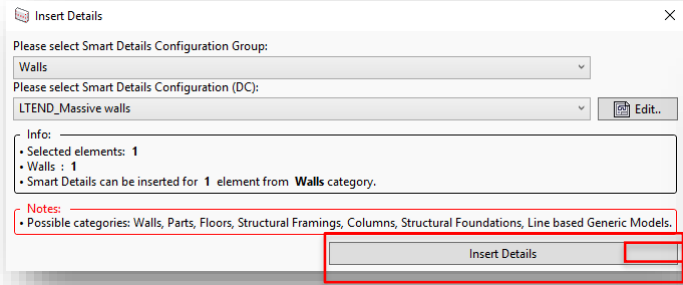
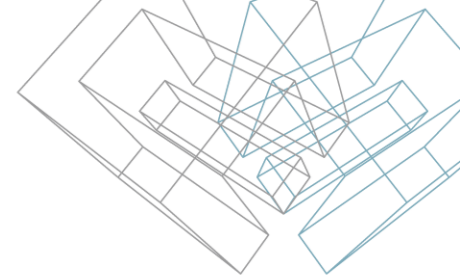

- If you select elements and 'Insert elements' command after that, you will see the 'Insert elements' window.
- Choose Smart Connections Configuration from pop-up window or choose to edit configurations by clicking Edit.
- If you are satisfied with the selected configuration – select 'Insert elements' and watch the process of inserting elements.

Insert Elements by Category

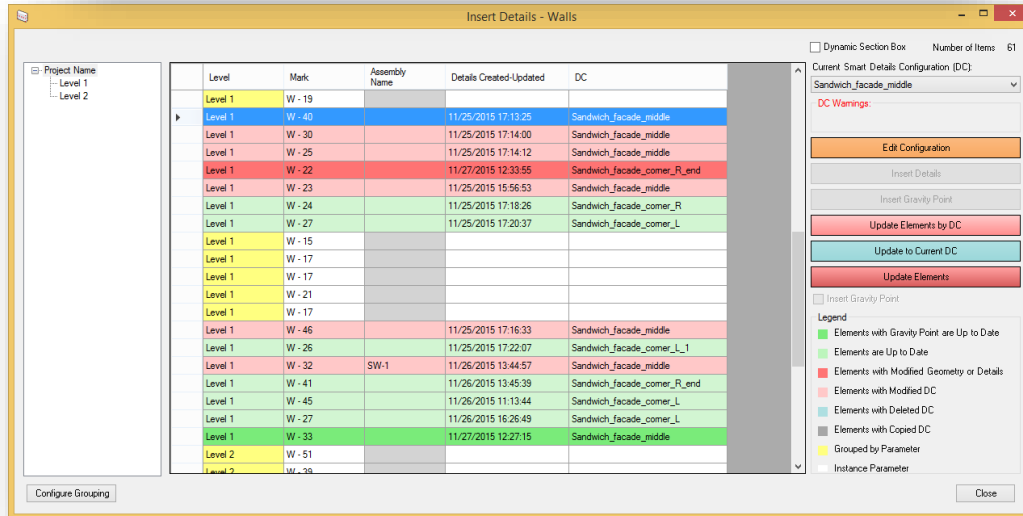
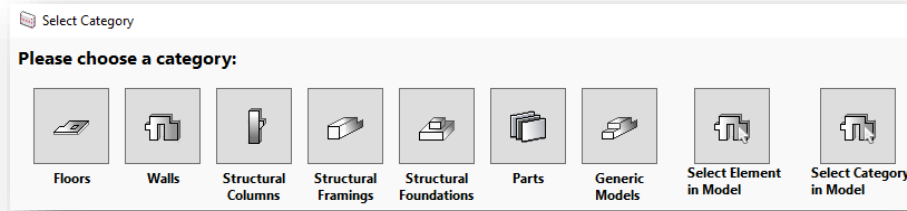
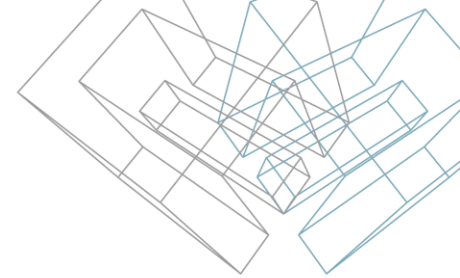

- If you don't select any element in Revit model and just click on Insert Elements commands, you will have to select category or the option Select Element in Model.
- If you select one of the categories available in your project – you will see such a window with all elements of this category.
- You can see the status of all elements and can edit, update, and insert elements to selected elements here.

Auto Insert Elements

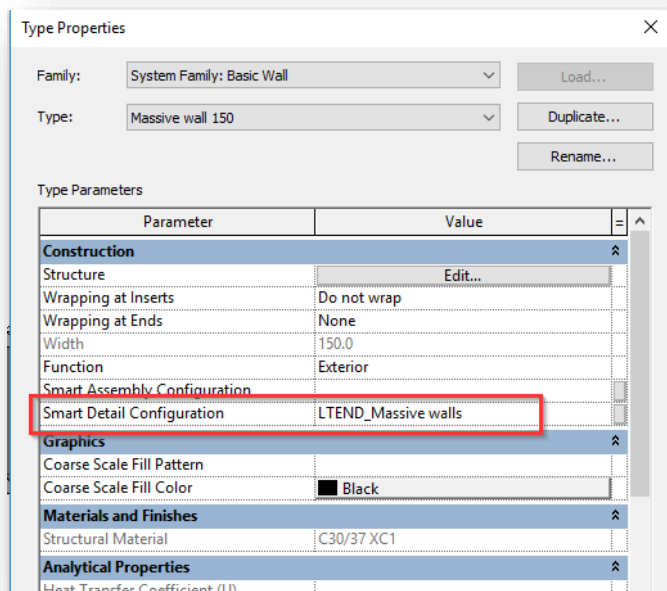
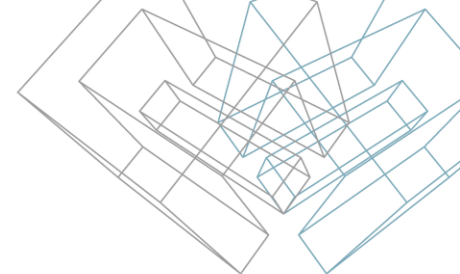

To use Auto Insert Element:

- Add configuration name to Smart Detail Configuration parameter.
(this Shared Parameter is added to your project automatically when you start using Smart Connections).
- Select elements.
- Click Auto Insert.
- It will automatically read the name of configuration which should be used and start inserting details.

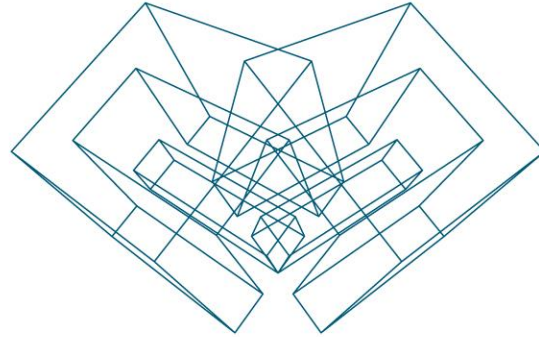

AGA CAD Ltd

T: +370 618 55671 | E: support@aga-cad.com | W: www.aga-cad.com